



Future of Bunbury Street Landscape

Landscape

In our initial conversations with residents, we heard calls for increased greenery along Bunbury Street.

The Street currently consists primarily of Elm trees with a few Ash trees intermingled, the avenue has been deteriorating over time. The 12 trees recently removed were shown to have poor support structures and extensive decay – with many hollow inside.

The soil condition is also poor in nutrients, rocky and compacted, and the backfill around the tunnel excavation is ballast rock. The creation of healthy soils is critical for the growth of healthy trees and plants. Below ground modifications and amelioration to improve soil volumes and soil quality, decompaction, fertilisation/organic matter incorporation, and increased



Native mix

soil moisture are needed to maximise tree growth.

The trees that are in good health with high amenity will be retained, and Council is proposing a range of strategies to increase the greenery along Bunbury Street to preserve the leafy nature of the street while respecting the heritage of the avenue and maintaining healthy and sound trees.



Floral display

Water Sensitive Urban Design can provide passive irrigation from storm water capture and distribution, and will improve soil moisture levels and water quality. The proposed installation of the passive irrigation will also be an opportunity to repair the bluestone spoon drain and reset subsided levels outside of the retained tree drip zones.



Woodland meadow



Varied foliage



Drought tolerant mix

Council is seeking your feedback on opportunities for the revitalised landscape. This includes:

- creating a double row of tree planting, which would see a second row of smaller stature trees (up to 60 additional small trees) installed over the three blocks while retaining healthy existing trees
- increased density of tree planting from 54 large canopy planting locations up to 84 tree locations while retaining the healthy trees in place
- highlighting intersections with planter beds
- investigating climate ready large canopy trees to incorporate into the heritage avenue planting
- increasing biodiversity values of the planting scheme

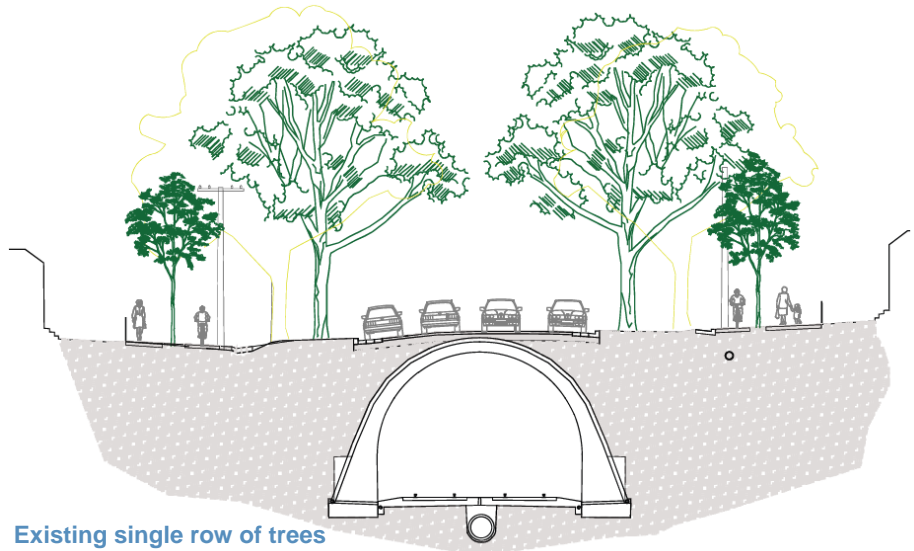

Existing single row of trees transitioning to a double row

In addition to an increased variety of flora within the streetscape the following ideas could also be implemented:

- reintroducing native flora
- supporting native fauna with landscape elements – incorporating hollows, nesting boxes and preferred flora into the landscape
- climate ready planting
- planting wildflower meadows in the proposed planter beds and or adjacent median strips and rockery from Moreland to Maribyrnong Street
- under story planting
- floral/ornamental planting schemes
- planting that supports local fauna
- the community's ideas for planting scheme(s)

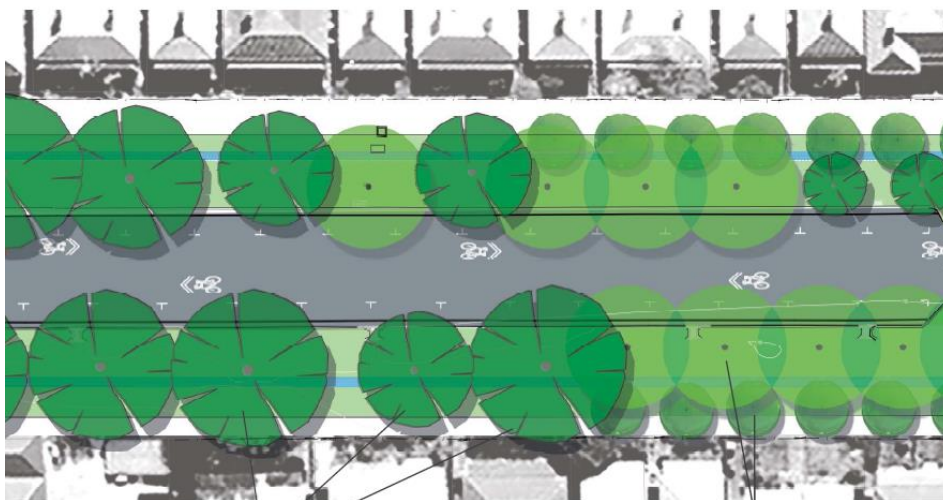

Existing single row of trees transitioning to a double row

In the eastern end of the street the landscape changes dramatically. The Maribyrnong River has carved away a slope here, which is a culturally significant space for the traditional owners. Increasing planting with a climate ready mix of planting with a focus on native species and tree canopy will improve air quality and reduce the heat island effect.

We are keen to understand if the community supports the new planting in the area and a planting character, which reflects the indigenous importance and climate sensitivity of the riverside area.

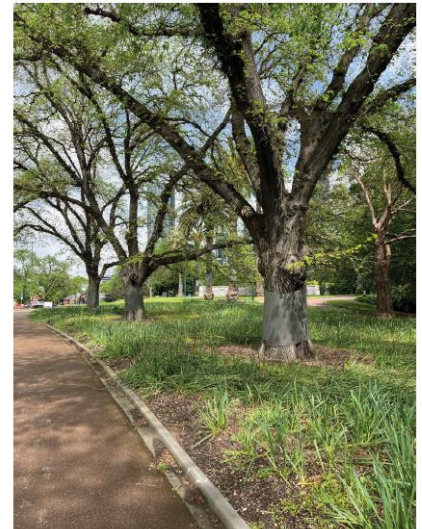

Understory planting

Share your thoughts

For more information, project updates and to share your thoughts online, visit

yourcityyourvoice.com.au/bunbury

You can also get in touch with us by emailing

CD@maribyrnong.vic.gov.au