

# The future of Bunbury Street

## Shared space option

### Existing condition

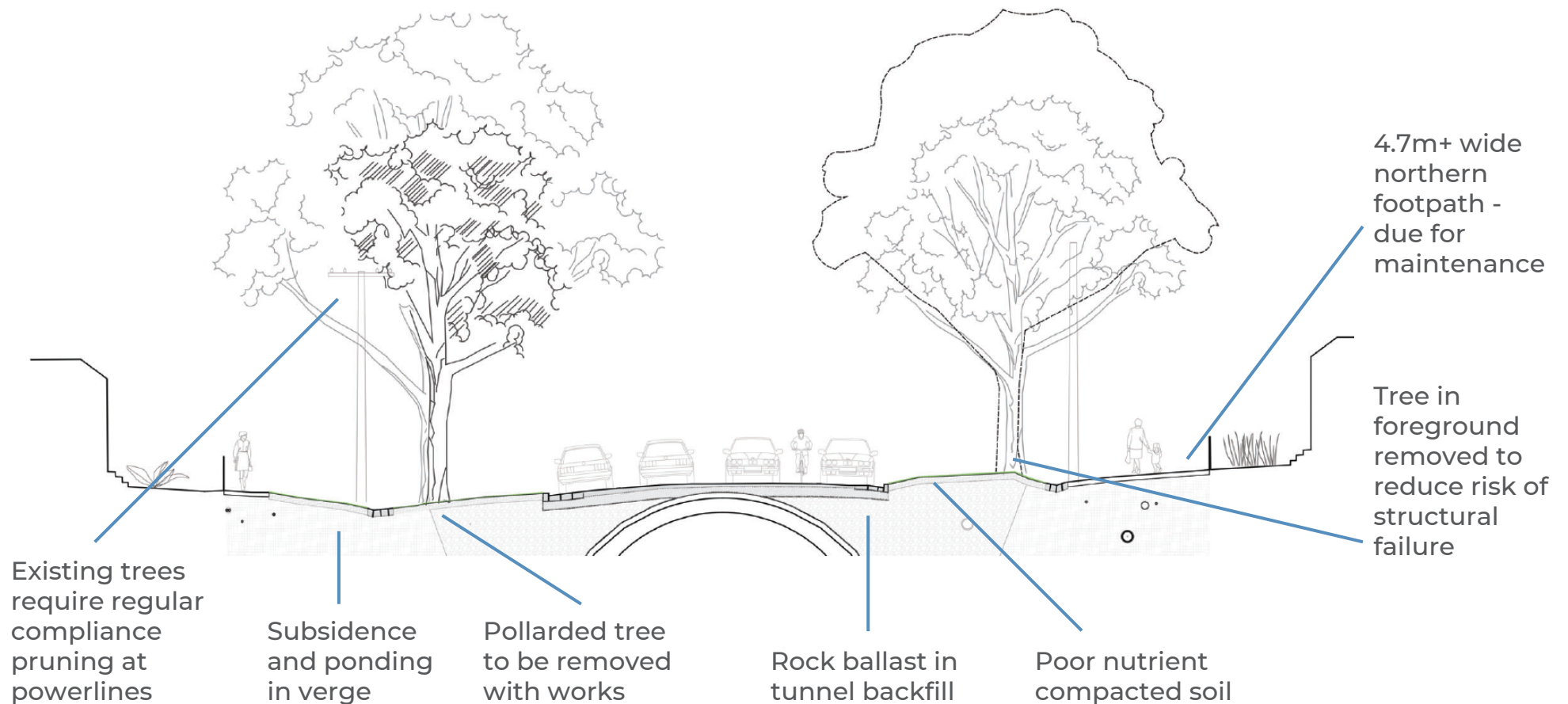

# The future of Bunbury Street

## Shared space option

### Endorsed design

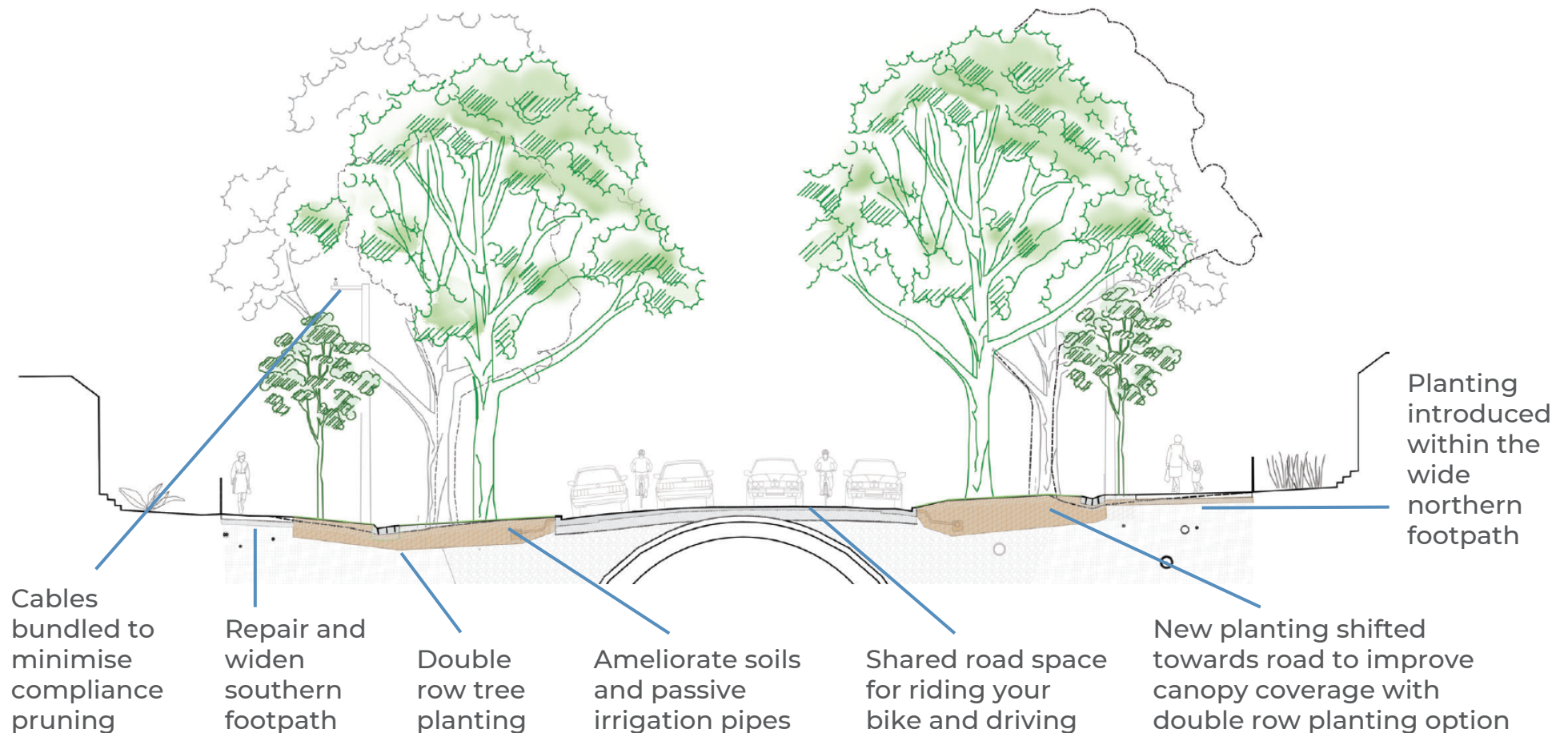

# The future of Bunbury Street

## Shared space option

### Endorsed design

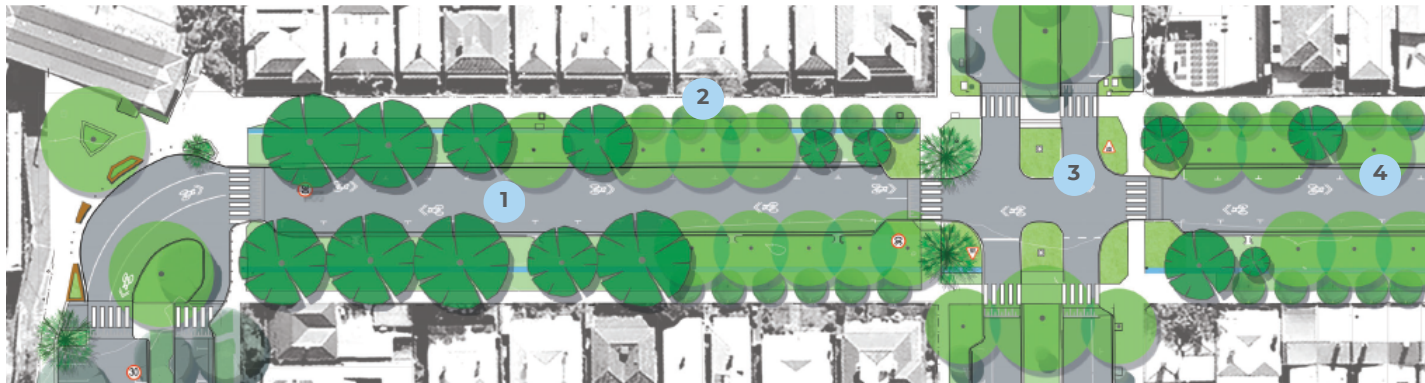

Hyde Street

Cowper Street



Whitehall Street

Moreland Street

- 1 Advocate for reduction in traffic speed to 30km/h
- 2 Planting within the wide northern footpath
- 3 New kerb outstands with enhanced planting
- 4 Maintaining on street parking adjacent to residential entrances
- 5 Maximising canopy coverage of planting
- 6 Improving pedestrian amenity at crossings
- 7 Continuation of wide footpath and verge with shift to parallel parking
- 8 Widening the southern footpath



# The future of Bunbury Street

## Shared space option

### Existing condition : Moreland to Maribyrnong Street connection

Poor canopy coverage

Stair only access to Bluestone cottages and stage entry

No footpath connection along the southern side

Poor sightlines and lack of pedestrian priority

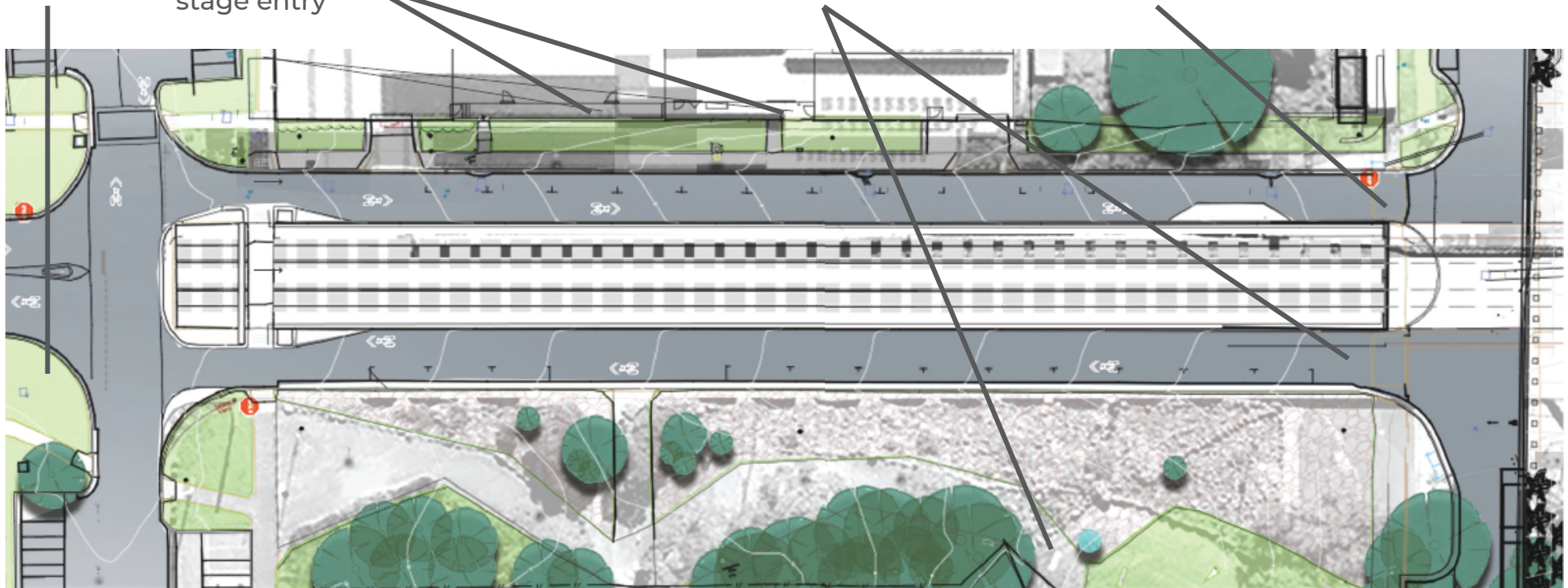

Moreland Street

Maribyrnong Street

# The future of Bunbury Street

## Shared space option



### Endorsed design: Moreland to Maribyrnong Street connection

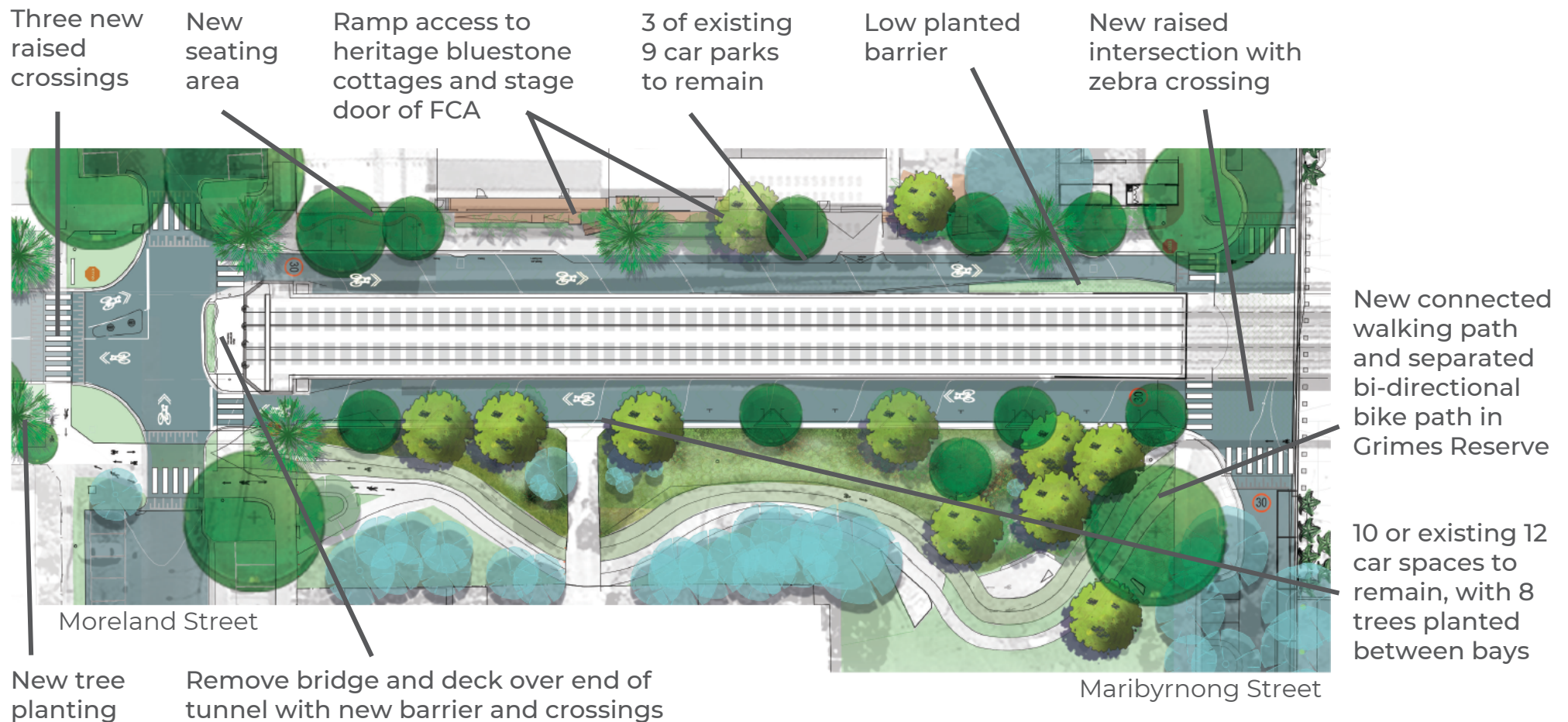

# The future of Bunbury Street

## Shared space option



### Heritage opportunities

Bunbury Street has a rich heritage. Originally a bank on the edge of a saltwater river, home to native flora, fauna and indigenous people, this location became an important connection to the west with the landing of the punt at the shore. It grew into a key avenue of Footscray connecting the punt to the new rail station and later the rail line cut through this same avenue. Today it connects the urban realm of Footscray to one of the premier open spaces in Maribyrnong.

The locations shown in orange are the areas where Council is interested in emphasising the heritage of the site.

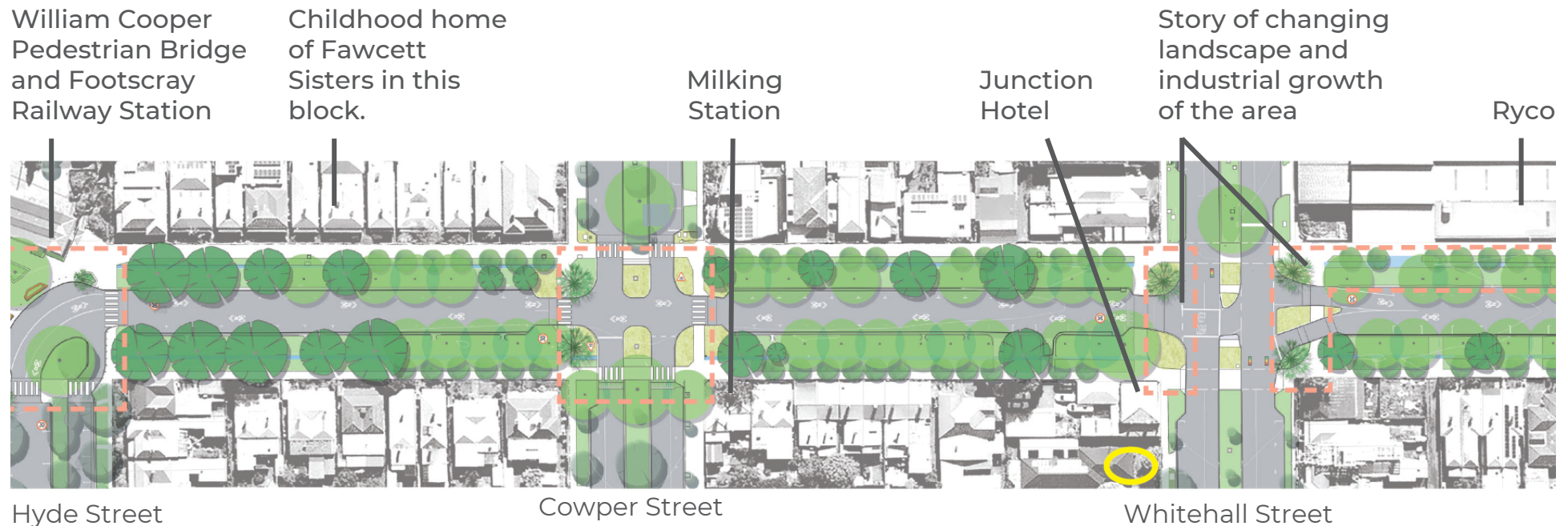



# The future of Bunbury Street

## Shared space option



### Heritage opportunities

The locations shown in orange are the areas where Council is interested in emphasising the heritage of the site.

In this area of cultural significance, there will be an emphasis on the natural environment, indigenous planting and how the indigenous people utilised the natural resources. Stories of the lesser known women in indigenous activism will be shared.

